

ROMANIA
CONSILIUL LOCAL SINANDREI
Judetul Timis, 307375 Sinandrei, Str. Principala nr. 516
Telefon: 0256/383500 fax:0256/383806

HOTARAREA Nr.82 din 12.08.2009
aprobarea atribuirii unor denumiri de strazi catorva locatii din
localitatea Carani Comuna Sinandrei Jud. Timis;

CONSILIUL LOCAL SINANDREI

Reunit in sedinta ordinara din data de 12.08.2009, avand in vedere Raportul nr.3687/14.07.2009 al inspectorului de specialitate din cadrul Compartimentului de urbansim si amenajare a teritoriului Primariei Comunei Sinandrei, D-na ing. Groza Livia Maria, cu privire la necesitatea aprobarii atribuirii unor denumiri de strazi catorva locatii din localitatea Carani Comuna Sinandrei Jud. Timis si emiterea unei hotarari in acest sens ;

Avand in vedere avizele Comisiei pentru invatamant, sanatate, cultura, sport, culte si protectie sociala, Comisiei de organizare si dezvoltare urbanistica, realizarea lucrarilor publice si protectia mediului inconjurator, si a Comisiei economico-sociale, buget, finante si administrarea domeniului public si privat a Comunei Sinandre din cadrul Consiliului Local al Comunei Sinandrei;

Avand in vedere documentatia, parte integranta din prezenta hotarare;

In conformitate cu prevederile art.2 lit.d, art.3 alin.1 si art.5 alin.1 din Ordonanta nr.63/2002 privind atribuirea sau schimbarea de denumiri cu modificarile si completarile ulterioare;

In temeiul prevederilor art.36 alin.2 lit.c si alin.5 lit.c, coroborat cu art.45 din Legea nr. 215/2001 privind Administratia Publica Locala, republicata cu modificarile si completarile ulterioare

HOTARASTE

Art.1 Se aproba atribuirea denumirii: Strada HERA – strazii amplasate in apropierea văii cunoscute sub denumirea de Valea Hera.

Art.2 Cu ducerea la indeplinire a prezentei hotarari se insarcineaza Compartimentul de urbanism si amenajare a teritoriului, din cadrul Primariei Comunei Sinandrei.

Art.3 Prezenta hotarare se comunica:

Institutia Prefectului - Judetului Timis - Directia de Control a
Legalitatii Actelor si Contencios Administrativ
Compartimentul de urbanism si amenajare a teritoriului, din
cadrul Primariei Comunei Sinandrei
Domnului Primar
O.C.P.I. Timis - Biroul de Carte Funciara
Prin afisaj, atentiei publice

**PRESEDINTE DE SEDINTA
ZARULEA COSTICA**

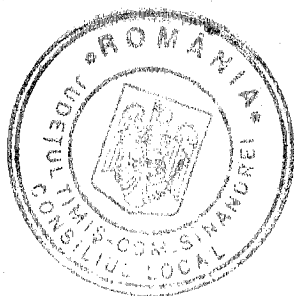

AVIZAT
Secretar Comuna
Jr. Achim Nicoleta Marta

| Nr. Crt. | Strada | Nr. postal vechi | Nr. postal nou | Nr. top. |
|----------|------------|---------------------|-------------------|-----------------------------------|
| 1 | 2 | 3 | 4 | 5 |
| 46 | Sf. Andrei | | 88 | 2519/1/1/a/38 |
| 47 | Sf. Andrei | | 89 | 2519/1/1/a/26 |
| 48 | Sf. Andrei | | 90 | 2519/1/1/a/37 |
| 49 | Sf. Andrei | | 91 | 2519/1/1/a/27 |
| 50 | Sf. Andrei | | 92 | 2519/1/1/a/36 |
| 51 | Sf. Andrei | | 93 | 2519/1/1/a/28 (Muntean) |
| 52 | Sf. Andrei | | 94 | 2519/1/1/a/35 |
| 53 | Sf. Andrei | | 95 | 2519/1/1/a/29 |
| 54 | Sf. Andrei | | 96 | 2519/1/1/a/34 |
| 55 | Sf. Andrei | | 97 | 2519/1/1/a/30; 2519/1/1/a/31 |
| 56 | Sf. Andrei | | 98 | 2519/1/1/a/33 |
| 57 | Sf. Andrei | | 100 | 2519/1/1/a/32 |
| 58 | Hera | | 1 | 2125/507-508/47/23/1/1/1/1/a/1/3 |
| 59 | Hera | | 3 | 2125/507-508/47/23/1/1/1/1/a/1/4 |
| 60 | Hera | | 5 | 2125/507-508/47/23/1/1/1/1/a/1/5 |
| 61 | Hera | | 7 | 2125/507-508/47/23/1/1/1/1/a/1/6 |
| 62 | Hera | | 9 | 2125/507-508/47/23/1/1/1/1/a/1/7 |
| 63 | Hera | | 11 | 2125/507-508/47/23/1/1/1/1/a/1/8 |
| 64 | Hera | | 13 | 2125/507-508/47/23/1/1/1/1/a/1/9 |
| 65 | Hera | | 15 | 2125/507-508/47/23/1/1/1/1/a/1/10 |
| 66 | Hera | | 17 | 2125/507-508/47/23/1/1/1/1/a/1/11 |
| 67 | Hera | | 19 | 2125/507-508/47/23/1/1/1/1/a/1/12 |
| 68 | Hera | | 21 | 2125/507-508/47/23/1/1/1/1/a/1/13 |
| 69 | Hera | | 23 | 2125/507-508/47/23/1/1/1/1/a/1/14 |
| 70 | Hera | | 25 | 2125/507-508/47/23/1/1/1/1/a/1/15 |
| 71 | Hera | | 27 | 2125/507-508/47/23/1/1/1/1/a/1/16 |
| 72 | Hera | | 29 | 2125/507-508/47/23/1/1/1/1/a/1/17 |
| 73 | Hera | | 31 | 2125/507-508/47/23/1/1/1/1/a/1/18 |
| 74 | Hera | | 33 | 2125/507-508/47/23/1/1/1/1/a/1/19 |
| 75 | Hera | | 35 | 2125/507-508/47/23/1/1/1/1/a/1/20 |
| 76 | Hera | | 37 | 2125/507-508/47/23/1/1/1/1/a/1/21 |
| 77 | Hera | | 39 | 2125/507-508/47/23/1/1/1/1/a/1/22 |
| 78 | Hera | | 41 | 2125/507-508/47/23/1/1/1/1/a/1/23 |
| 79 | Hera | | 43 | 2125/507-508/47/23/1/1/1/1/a/1/24 |
| 80 | Hera | | 45 | 2125/507-508/47/23/1/1/1/1/a/1/25 |
| 81 | Hera | | 47 | 2125/507-508/47/23/1/1/1/1/a/1/26 |
| 82 | Hera | | 49 | 2125/507-508/47/23/1/1/1/1/a/1/27 |
| 83 | Hera | | (51) | 2125/507-508/47/23/1/1/1/1/a/1/28 |
| 84 | Hera | | 53 | 2125/507-508/47/23/1/1/1/1/a/1/29 |
| 85 | Hera | | 55 | 2125/507-508/47/23/1/1/1/1/a/1/30 |
| 86 | Hera | | 57 | 2125/507-508/47/23/1/1/1/1/a/1/31 |
| 87 | Hera | | 59 | 2125/507-508/47/23/1/1/1/1/a/1/32 |
| 88 | Hera | | 61 | 2125/507-508/47/23/1/1/1/1/a/1/33 |
| 89 | Hera | | 63 | 2125/507-508/47/23/1/1/1/1/a/1/34 |
| 90 | Hera | | 65 | 2125/507-508/47/23/1/1/1/1/a/1/35 |
| 91 | Hera | | 67 | 2125/507-508/47/23/1/1/1/1/a/1/36 |
| 92 | Hera | | 69 | 2125/507-508/47/23/1/1/1/1/a/1/37 |

90A COSTE
90B
POTRONG

POZ 609

POZ 623 →

97A-POZ V
97B-POZ
97C-POZ

FETT
SAN

KUSU
CRISTINA

SALAI Y

Halasz
Mihailor

DEJNARIU
GRUBA LIA

| <i>Nr. Crt.</i> | <i>Strada</i> | <i>Nr. postal vechi</i> | <i>Nr. postal nou</i> | <i>Nr. top.</i> |
|-----------------|-------------------|-----------------------------|---------------------------|-----------------------------------|
| 1 | 2 | 3 | 4 | 5 |
| 93 | Hera | | 71 | 2125/507-508/47/23/1/1/1/1/a/1/38 |
| 94 | Hera | | 73 | 2125/507-508/47/23/1/1/1/1/a/1/39 |
| 95 | Intrarea Stelelor | 676/D | 1 ✓ | 3181/997/3/1 (nr. cad nou 50769) |
| 96 | Intrarea Stelelor | 676/B | 2 ✓ | 3181/997/3/4 |
| 97 | Intrarea Stelelor | | 3 | 3181/997/3/2 |

30' SF. ANDREI P 20/2 ~~77/A~~ 2519/1/1/a/20/2 - provizorie

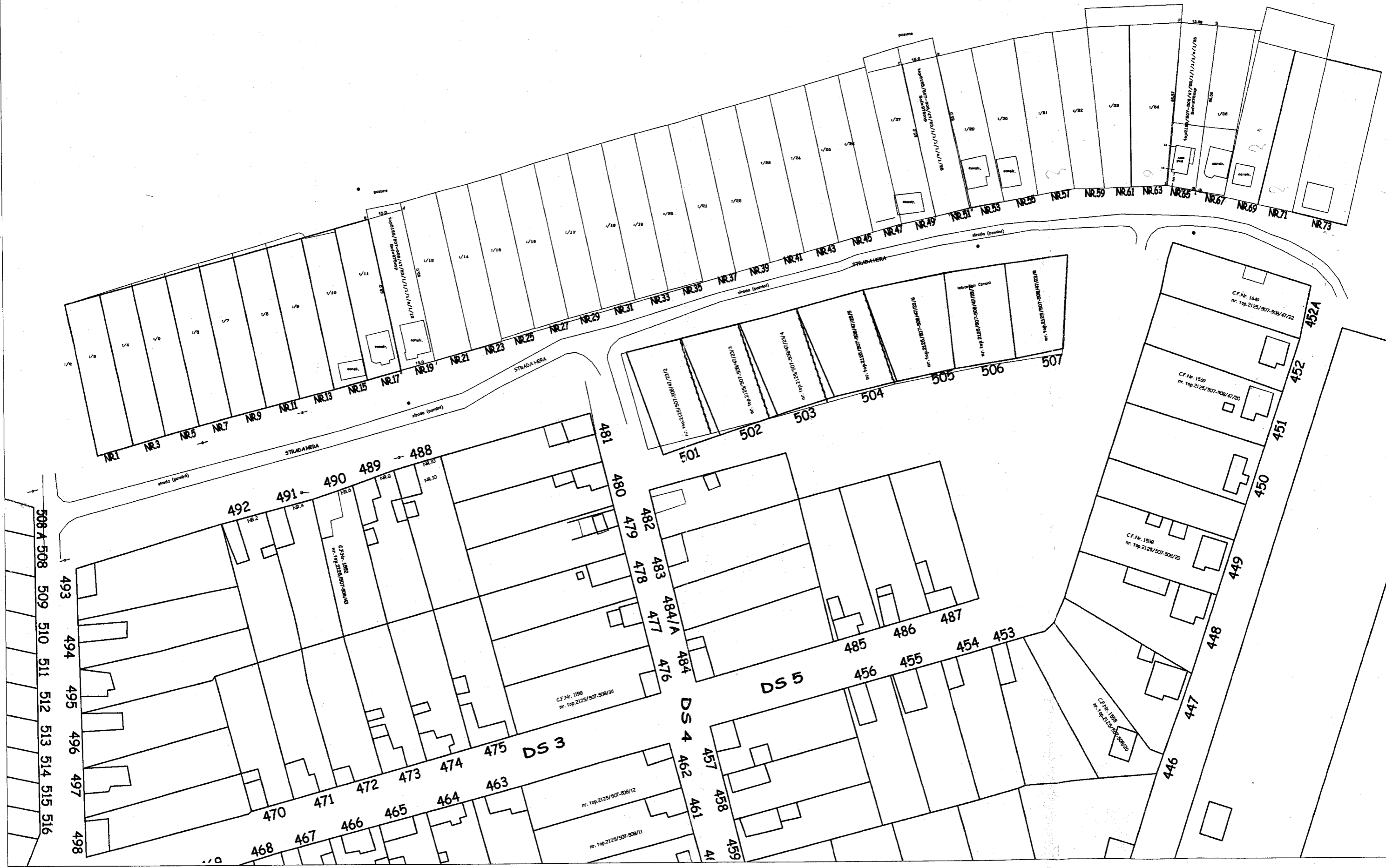

508 A 508 509 510 511 512 513 514 515 516

492 491 490 489 488

CF Nr. 1098
nr. top. 2125/507-508/36

nr. top. 2125/507-508/12

nr. top. 2125/507-508/11

DS 3

DS 5

DS 4

CF Nr. 1538
nr. top. 2125/507-508/20

CF Nr. 1598
nr. top. 2125/507-508/20

CF Nr. 1640
nr. top. 2125/507-508/47/22

CF Nr. 1569
nr. top. 2125/507-508/47/20

1/27
1/28
1/24
1/26
1/24
1/26
1/28
1/30
1/31
1/32
1/33
1/34
1/35
1/36

1/10
1/14
1/16
1/18
1/18
1/20
1/21
1/22

1/8
1/4
1/6
1/8
1/8

NR.1
NR.3
NR.5
NR.7
NR.9
NR.11
NR.13
NR.15
NR.17
NR.19
NR.21
NR.23
NR.25
NR.27
NR.29
NR.31
NR.33
NR.35
NR.37
NR.39
NR.41
NR.43
NR.45
NR.47
NR.49
NR.51
NR.53
NR.55
NR.57
NR.59
NR.61
NR.63
NR.65
NR.67
NR.69
NR.71
NR.73

501
502
503
504
505
506
507

452A
452
451
450
449
448
447
446

481
480
479
482
478
483
484/A
477
484
476

485
486
487
456
455
454
453

470
471
472
473
474
463
464
465
466
467
468

457
458
459